

- 1) counterbore for screw DIN 912 / ISO 4782 - M4 (4x) used from top-side or optional M5; depth 10 used from bottom-side
- 2) M4; depth 3,5 (4x)
- 3) terminal (number and types of connectors depending on selected equipment)

requirement on mounting surfaces: flatness 0.02 mm

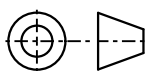

drawingscale: 1:1  
metric system (mm)

Revision 10/2022

Doc-Nr. 434041